

# Plaques bimétalliques cuivre/aluminium

- Plaques bimétalliques cuivre/aluminium

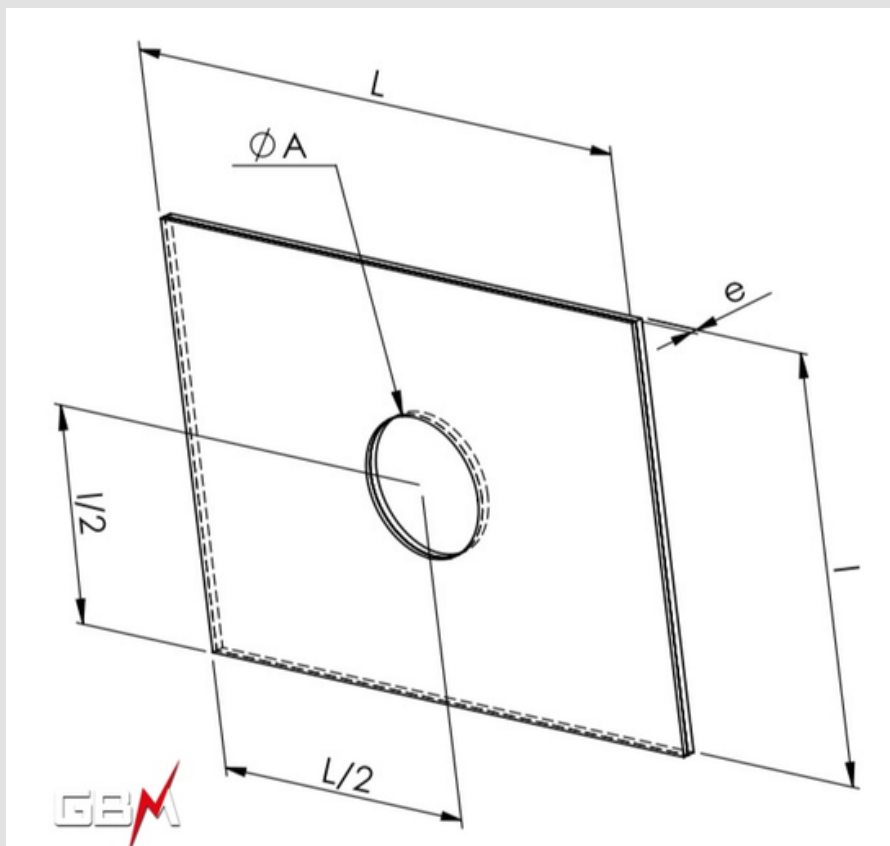

| Référence | Dimensions L x l x e (mm) | ØA (mm) | Poids/100 pièces (Kgs) | Conditionnement |
|-----------|---------------------------|---------|------------------------|-----------------|
| PBI8.5    | 55x40x1                   | 8.5     | 0.8                    | 50              |
| PBI10.5   | 55x40x1                   | 10.5    | 0.8                    | 50              |
| PBI13     | 55x40x1                   | 13      | 0.77                   | 50              |
| PBI14.5   | 55x40x1                   | 14.5    | 0.75                   | 50              |
| PBI16.5   | 55x40x1                   | 16.5    | 0.70                   | 50              |